

CRANK SPECIFICATIONS

Top-quality architectural shading systems for optimum solar control

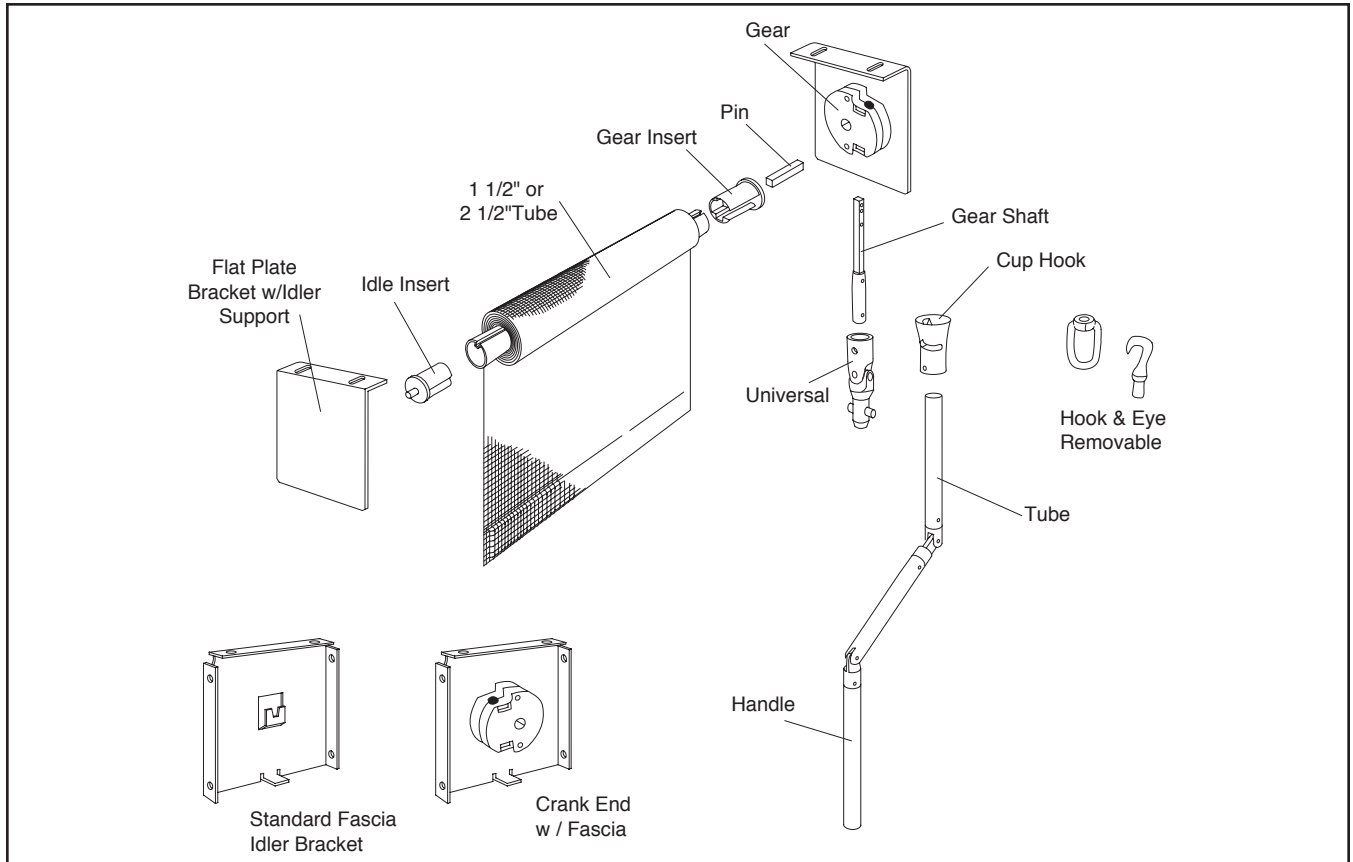

Tech™ Shades - Crank Systems

The superb styling of the Tech™ Shade by SKYCO Shading Systems offers excellent light and glare control with an uninterrupted view to the exterior. Blackout materials are offered for complete control. the crank mechanism is to be specified for large oversized shades and special conditions where standard manual shades will not work and motorization is not a viable alternative. Crank operators are an excellent alternative for exterior applications where chains are not recommended. The shade presents the same appearance, inside and out, so they are ideal for many different architectural settings. All Tech™ Shades by SKYCO Shading Systems Inc. are custom-made to your exact size, color and material specifications.

Gears

The gear ratios are available from 3/1 to 14/1 for any size lift requirements. Standard gears for interior use are as follows:

- Ratio 3/1
0.2 m kg (16 in lb) - 21mm (13/16") thick
- Ratio 5/1
0.3 m kg (18 in lb) - 21mm (13/16") thick
- Ratio 14/1 heavy duty
1 5/8" thick x 3" deep
Hook and eye removeable attachment of pole only.

Brackets and Plates

Angle brackets and support plates are available for light and heavy duty installations. In addition, standard 3" and 4" fascia and brackets can be adapted to mount crank shade hardware.